

**PROGEF Standard**  
**Valve end 546 and 543 (G37)**  
**With butt fusion spigot long SDR11 metric**

**Model:**

- Material: PP-H

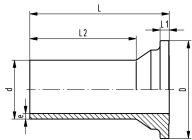

| d<br>(mm) | PN<br>(bar) | Code               | SP | Weight<br>(kg) | e<br>(mm) | L1<br>(mm) | D<br>(mm) | L<br>(mm) | L2<br>(mm) |
|-----------|-------------|--------------------|----|----------------|-----------|------------|-----------|-----------|------------|
| 20        | 10          | <b>167 482 956</b> | 1  | 0.012          | 2.3       | 4          | 38        | 69        | 53         |
| 25        | 10          | <b>167 482 957</b> | 1  | 0.020          | 2.3       | 5          | 44        | 76        | 58         |
| 32        | 10          | <b>167 482 958</b> | 1  | 0.029          | 2.9       | 5          | 53        | 76        | 58         |
| 40        | 10          | <b>167 482 959</b> | 1  | 0.048          | 3.7       | 5          | 65        | 82        | 61         |
| 50        | 10          | <b>167 482 960</b> | 1  | 0.082          | 4.6       | 6          | 77        | 91        | 63         |
| 63        | 10          | <b>167 482 961</b> | 1  | 0.154          | 5.8       | 7          | 99        | 110       | 77         |

The technical data are not binding. They neither constitute expressly warranted characteristics nor guaranteed properties nor a guaranteed durability. They are subject to modification. Our General Terms of Sale apply.

Georg Fischer Piping Systems Ltd, Postfach, CH-8201 Schaffhausen/Switzerland

Phone +41 -(0)52-631 1111

e-mail: [info.ps@georgfischer.com](mailto:info.ps@georgfischer.com)

Internet: <http://www.gfps.com>