

PROGEF Standard Flange adaptor SDR11 (PN10) for butterfly valves
Joining face flat

Model:

- Material: PP-R
- Conventional butt-welding according to DVS 2207
- Suitable for butterfly valve type 567/578 and 038/039

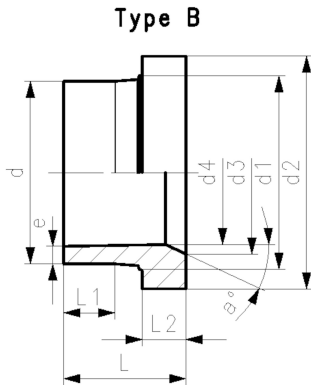

d	DN	Code	Weight	d1	d2	d3	d4	L	L1	L2	e	Type	a°
(mm)	(mm)		(kg)	(mm)	(mm)	(mm)	(mm)	(mm)	(mm)	(mm)	(mm)		
355	350	727 798 924	7.300	373	430	350	284	187	70	65	33.9	B	25
400	400	727 798 925	10.200	427	482	400	320	196	70	70	38.2	B	25
450	500	727 798 926	17.900	467	533	450	360	272	105	107	43.0	B	23
500	500	727 798 927	20.100	530	585	498	400	261	105	90	47.8	B	25

The technical data are not binding. They neither constitute expressly warranted characteristics nor guaranteed properties nor a guaranteed durability. They are subject to modification. Our General Terms of Sale apply.

Georg Fischer Piping Systems Ltd, Postfach, CH-8201 Schaffhausen/Switzerland

Phone +41 -(0)52-631 1111

e-mail: info.ps@georgfischer.com

Internet: <http://www.gfps.com>