



Backing flange PP-Steel metric For socket systems metric and BS

Model:

- **Bolt circle PN 10**
- PP-GF (30% glass-fibre reinforced) with steel ring
- UV-resistant. Applicable for outside applications
- Connecting dimension: ISO 7005, EN 1092, BS 4504, DIN 2501

AL: number of holes

¹⁾ Suitable for socket -and butt fusion systems

²⁾ Not for BS

³⁾ Connecting dimension: ISO 2536. bolt circle acc. DN125. suitable for flange adaptor d125/ DN100

⁴⁾ Connecting dimension: ISO 2536. bolt circle acc. DN225. suitable for flange adaptor d250/ DN250

⁵⁾ Combined version, bolt circle metric - ANSI

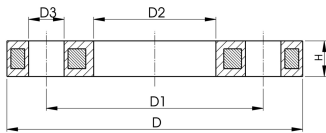
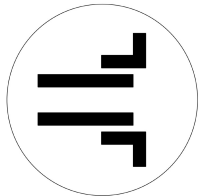

	d	DN	PN	Code	Weight	D1	D3	D2	D	H	AL	SC
	(mm)	(mm)	(bar)		(kg)	(mm)	(mm)	(mm)	(mm)	(mm)		
1	20	15	16	727 700 206	0.216	65	14	28	95	12	4	M12
1	25	20	16	727 700 207	0.279	75	14	34	105	12	4	M12
1	32	25	16	727 700 208	0.429	85	14	42	115	16	4	M12
1	40	32	16	727 700 209	0.621	100	18	51	140	16	4	M16
1	50	40	16	727 700 210	0.722	110	18	62	150	20	4	M16
1	63	50	16	727 700 211	1.084	125	18	78	165	20	4	M16
1	75	65	16	727 700 212	1.349	145	18	92	185	20	4	M16
	90	80	16	727 700 213	1.369	160	18	110	200	20	8	M16
2	110	100	16	727 700 214	1.522	180	18	133	220	20	8	M16
3	125	125	16	727 700 815	2.475	210	18	150	250	26	8	M16
	140	125	16	727 700 816	2.033	210	18	167	250	26	8	M16
2/5	160	150	16	727 700 817	3.167	241	22	190	285	26	8	M20
5	200	200	16	727 700 819	6.143	297	22	226	340	29	8	M20
5	225	200	16	727 700 820	4.448	297	22	250	340	29	8	M20
	250	250	16	727 700 821	7.179	350	22	277	395	32	12	M20
4	250	225	16	727 700 031	8.340	325	22	277	395	32	8	M20
	280	250	16	727 700 822	5.547	350	22	310	395	32	12	M20
	315	300	16	727 700 823	6.980	400	22	348	445	36	12	M20
	355	350	16	727 700 824	12.465	460	23	388	515	42	16	M20
	400	400	16	727 700 825	17.607	515	26	442	574	42	16	M24

The technical data are not binding. They neither constitute expressly warranted characteristics nor guaranteed properties nor a guaranteed durability. They are subject to modification. Our General Terms of Sale apply.

Georg Fischer Piping Systems Ltd, Postfach, CH-8201 Schaffhausen/Switzerland

Phone +41 -(0)52-631 1111

e-mail: info.ps@georgfischer.com

Internet: <http://www.gfps.com>